



IAdeaCare

Your Organization's Device Management, Fully Covered.

Device Provisioning and Administration



- Essential device administration controls
- Full control over IAdeaCare deployment
- Remote device diagnostic and forensics
- Batch administration for device control

Device Intelligence and Analytics



- Device inventory and contract management
- Device health and status analytics

Device Access Control and Security



- Central regulation of device access control
- Create alerts to monitor device status
- Device warranty and license tracking

NEW with an IAdeaCare Enterprise Account



- Role-based administration
- Single Sign On (SSO)
- Group-based policy management
- Granular permissions and account security

IAdeacare is comprehensive device management for all deployed IAdea devices, including essential tools for deployment, management, ongoing maintenance, and troubleshooting. IAdeacare consolidates operational data from all your devices into a single intuitive interface for in-depth analysis or quick at-a-glance viewing.

Accelerate deployments, reduce or automate management tasks, cut downtime with preventative maintenance, and streamline troubleshooting.

Large enterprises and educational institutions utilize IAdeaCare daily for water-tight management and optimization of networks ranging from a handful of devices all the way to mass deployments.



Start your free
IAdeaCare trial!

IAdeaCare Enterprise Account

Enterprise-Exclusive Remote Device Management That Keeps Pace with Organizational Growth

Upgrade your enterprise's device management processes with clearly defined admin roles and permissions, streamlined troubleshooting, and enhanced remote capabilities.

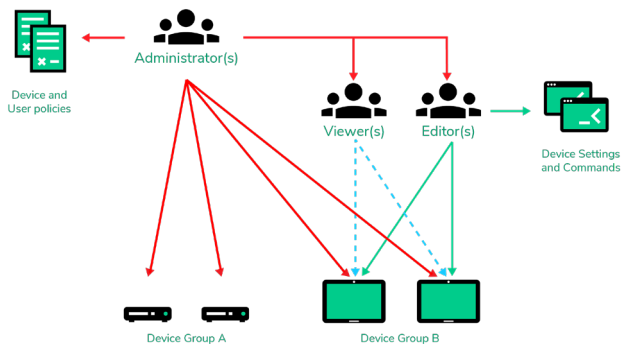

Full Control with Role-Based Admin

Admins can easily appoint other admins or designate users as Editors or Viewers to delegate management tasks. Easily establish and grant only the necessary permissions and privileges to eliminate productivity bottlenecks.

Passwords a Thing of the Past with SSO

Striking the balance between security and convenience, SSO with Azure AD integration keeps productivity on track. No need to remember complex passwords or deal with endless password recovery requests.

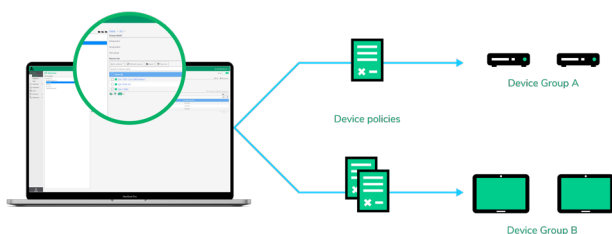

Device Grouping and Policy Execution

Admins can, with the utmost ease, group devices as desired and assign them to a user or user group to delegate management tasks. Admins can furthermore define policies and apply them to selected device groups or modify policies that automatically update to associated devices to ensure optimal operation.

Further available with Enterprise

- Third-party app management
- Branded experience
- User activity and device change logs
- Rogue device prevention
- SCEP support

License Type Comparison

| Feature | Description | Functions | Standard | Premium |
|--|--|---|----------|---------|
| Device Provisioning and Administration | | | | |
| Essential device administration controls | Configure individual device identity and network settings, generate support tickets, and update firmware locally | Local device configuration: name, application URL, output orientation, time zone, and daily reboots | • | • |
| | | Delayed device screenshot | | |
| | | Local firmware updates | | |
| | | Device list filtering | | |
| | | Device registration and pairing | | |
| Device grouping and batch administration with filter functions | Group devices for easier management or use filters to quickly find devices | Custom device groups creation | • | • |
| | | Device list filtering | | |
| Default configuration for device and device groups | One-step device enlisting process enables easier management over large groups of devices | Automatically apply policies and configurations to associated devices | | • |
| Full control over IAdeaCare deployment | Execute silent rollouts for IAdeaCare to minimize operational disruption | Account-based device activity overview | | • |
| | | IAdeaCare policy updates | | |
| Remote device diagnostics | Audit device performance, connectivity, health issues, playback screenshots, and perform basic troubleshooting | Real-time display screenshots | | • |
| | | Daily reboot scheduling | | |
| | | Remote device configuration | | |
| | | Device log retrieval | | |
| | | Remote firmware updates | | |
| | | Firmware update scheduling | | |
| Device power routine policy | Preventive maintenance prolongs device lifetime and promotes a greener workplace | Power on/off scheduling | | • |
| Device maintenance | Execute device updates with minimal interruption | Automatic device maintenance screen | | • |
| Device Intelligence and Analytics | | | | |
| Device inventory and license management | Device license and warranty information | Device warranty information | | • |
| | | Device license management | | |
| Device health analytics and troubleshooting | Set policies and procedures to generate periodic device status reports. Reduce diagnostic time and optimize uptime | One-click status report and troubleshooting | • | • |
| | | Audit device and user activity logs | | |
| | | Device heartbeat | | |
| Device Access Control and Security | | | | |
| Central management of device local access control | Features and tools to preserve device integrity and confidential data | Admin password setup | | • |
| | | Daily administrator password changes | | |
| | | Unauthorized device and content updates via USB port prevention | | |
| | | REST API access restriction | | |
| Alerts | Define triggers for email alerts | | | • |

Account Type Comparison

| Feature | Description | Functions | Standard | Enterprise |
|--|---|---|----------|------------|
| Device Provisioning and Administration | | | | |
| IAdeaCare deployment | Execute silent rollouts of IAdeaCare to minimize operational disruption | Pre-deployment configuration (Zero Touch Deployment) | | • |
| Role-based admin 🔥 | Centrally defines and manages hierarchy-wide security access | Add and remove users and their permissions | | • |
| | | Assignment of device groups to user groups | | |
| | | Define user roles (Administrator/Editor/Viewer) | | |
| Third-party app management 🔥 | Multi-platform app management from a single portal | Remote distribution, management, and tracking of apps | | • |
| Device Access Control and Security | | | | |
| SCEP support 🔥 | Streamline the certificate enrollment process of managed devices | Automatic certificate issuance | | • |
| Single Sign On (SSO) 🔥 | Access all applications after logging in once | SSO integration with Azure AD | | • |
| Others | | | | |
| Branded Experience 🔥 | Add your company's logo to the software and modify interface background | | | • |



IAdea America Corp

20 Fairbanks, Suite 170
Irvine, CA 92618
USA

+1-949-305-6489
us-sales@iadea.com

IAdea HQ

3F, No.21, Lane 168, Xingshan Road,
Neihu District, Taipei City, 114
Taiwan (ROC)

+886-2-2791-1110
sales@iadea.com



www.IAdea.com